

33C 1.20

5559112779

41981 PIV.

SCAN 71, 3000, CIVIL-7
 2 BNL - 5-114
 18W
 3500

APPROVED
 17/05/2014
 7/3/2014

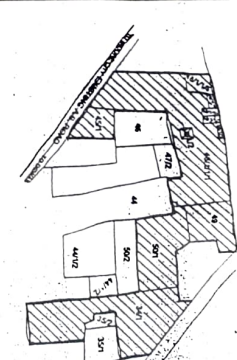

KIVGIA PLAN
 SCALE: 1:4000
 N

PROPOSED RESIDENTIAL LAY OUT PLAN ON LAND BEARING KH.NO.45/1,24/1,48/1/1/1,49,50/1, 48/1/1/3, 48/1/1/4,48/1/3,48/1/1/5,48/1/1/2 AT VILLAGE RAHU KHEED TEH SAWNER DIST INDORE

- B.T.O. -
- (1) SEE MAIN PLAN SO SEE SCHEDULE
 - (2) SEE SCHEDULE DATED 20 SEP 2014 & OTHERS
 - (3) SEE SCHEDULE SO SEE SCHEDULE & OTHERS
 - (4) SEE SCHEDULE SO SEE SCHEDULE & OTHERS
 - (5) SEE SCHEDULE SO SEE SCHEDULE & OTHERS
 - (6) SEE SCHEDULE SO SEE SCHEDULE & OTHERS
 - (7) SEE SCHEDULE SO SEE SCHEDULE & OTHERS

INDIAN LANK TOWNSHIP PVT. LTD.
 THESE DOCUMENTS ARE RESERVED BY INDIAN LANK TOWNSHIP PVT. LTD.
 S (MAY) (2014) OF A.M.S.

ITEM	UNIT	AMOUNT	REMARKS
TOTAL COST OF THE PROJECT	RS.	100000000	
CONSTRUCTION COST	RS.	80000000	
LAND ACQUISITION COST	RS.	20000000	
PERMITTING COST	RS.	10000000	
MARKETING COST	RS.	5000000	
CONTINGENCY	RS.	5000000	
TOTAL PROJECT COST	RS.	100000000	
SALES PRICE PER UNIT	RS.	10000000	
NUMBER OF UNITS		1000	
TOTAL SALES REVENUE	RS.	100000000	
NET PROFIT	RS.	20000000	
NET PROFIT PERCENTAGE	%	20	

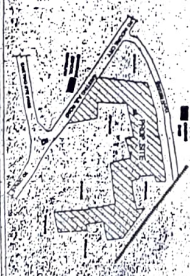

SCALE: 1:4000
 DATE: 15/05/2014
 DRAWN BY: M. SHARMA
 CHECKED BY: M. SHARMA

INDIAN LANK TOWNSHIP PVT. LTD.
 100, 101, 102, 103, 104, 105, 106, 107, 108, 109, 110, 111, 112, 113, 114, 115, 116, 117, 118, 119, 120, 121, 122, 123, 124, 125, 126, 127, 128, 129, 130, 131, 132, 133, 134, 135, 136, 137, 138, 139, 140, 141, 142, 143, 144, 145, 146, 147, 148, 149, 150, 151, 152, 153, 154, 155, 156, 157, 158, 159, 160, 161, 162, 163, 164, 165, 166, 167, 168, 169, 170, 171, 172, 173, 174, 175, 176, 177, 178, 179, 180, 181, 182, 183, 184, 185, 186, 187, 188, 189, 190, 191, 192, 193, 194, 195, 196, 197, 198, 199, 200